



CHARGE GUARDS

Intelligent Split Charging Battery Management

Charge Guard (AVSPC10/20 12/24 V):

Fitting Instructions

- Connect positive (+) from starting battery to pin 1
- Connect positive (+) of auxiliary to auxiliary battery to pin 2
- Connect earth (-) to pin 3

Operation

When the engine is running the device senses the voltage from the alternator and allows the battery to charge the auxiliary battery.

When the voltage to the main battery drops the unit isolates and separates both batteries. This means the starting battery will always have enough power to start and the auxiliary battery will never be able to drain it.

Operational voltages (12V) 13.4 – 12.6V & (24V) 27.0 – 25.4V.

An essential unit especially where “intelligent” alternators are fitted.

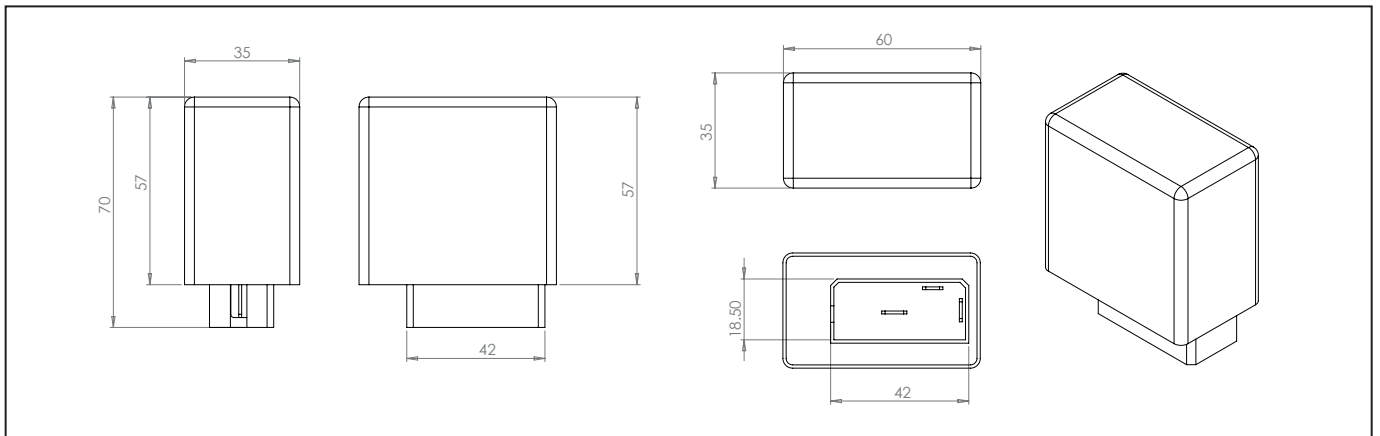
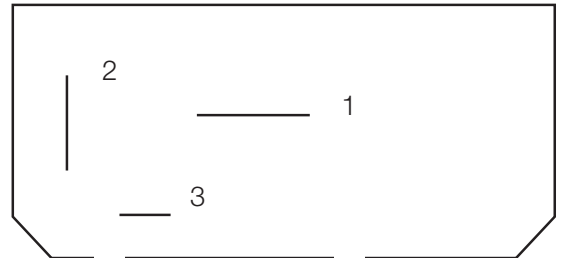

Charge Guard (AVSPC11/21 12/24 V):

Fitting Instructions

- Connect positive (+) from starting battery to pin 1
- Connect positive (+) of auxiliary to auxiliary battery to pin 2
- Connect earth (-) to black lead
- Connect positive (+) sense to red lead

Operation

When the ignition is on, the unit automatically charges the auxiliary battery.

Operational voltages (12V) 13.4 – 12.6V & (24V) 27.0 – 25.4V.

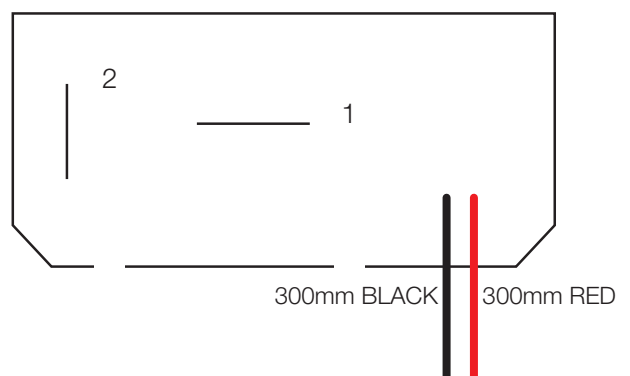

Problems with flat batteries? Auxiliary equipment draining your starting battery? Fed up with expensive call outs?

Fit CHARGE GUARD and save time and money

Solidstate fully encapsulated electronics